

Proposed Uncontrolled Pedestrian Crossing
into Millwood Housing Estate
as detailed in TII Publication CC-SCD-05123
and CC-SCD-05136

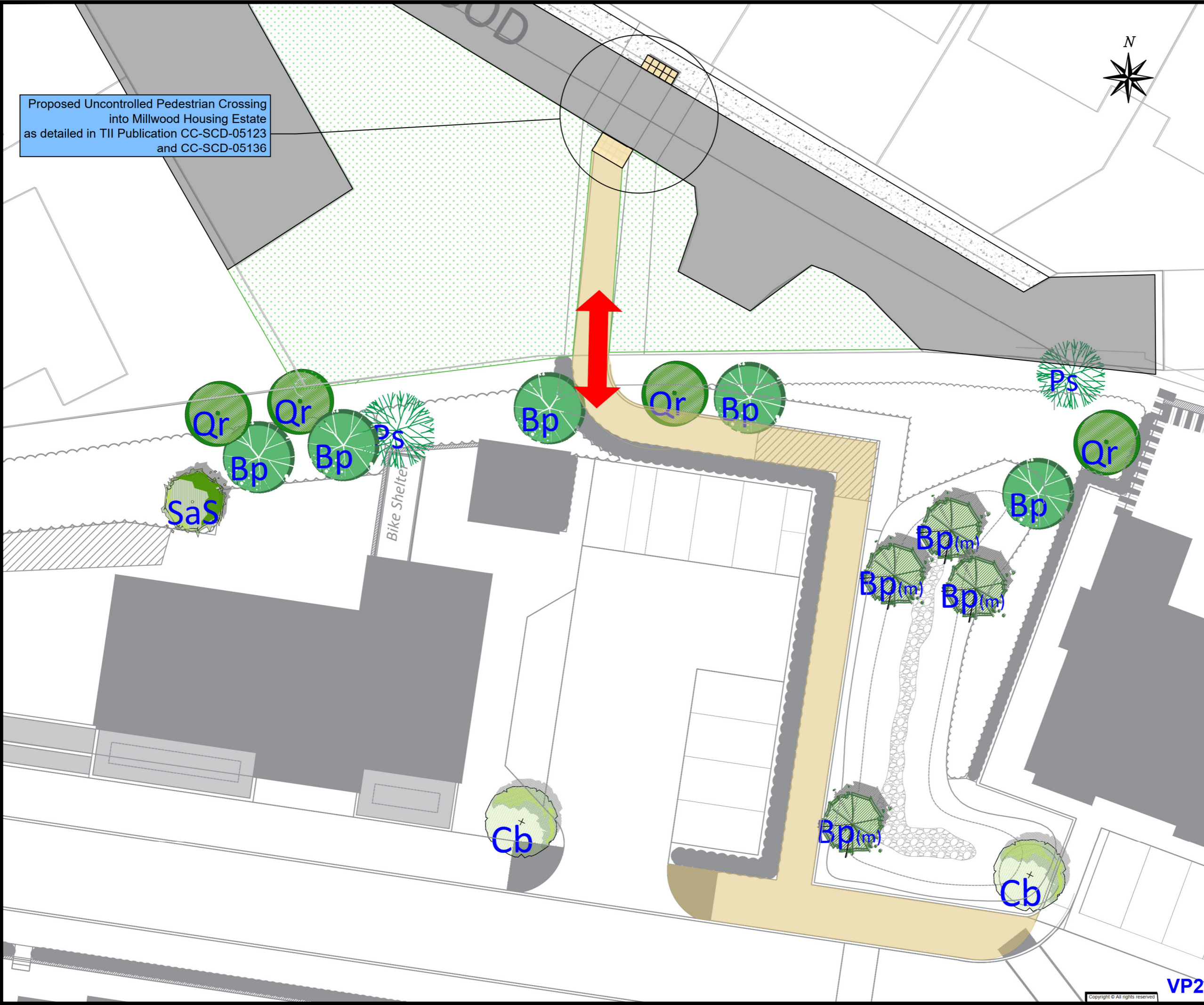

NOTES:
All dimensions in metres.
Do not scale from drawing.
For any discrepancies found please consult with design office.
This drawing is for PLANNING purposes only.
Not for Construction.

- Legend:**
-  Existing Green Area
 -  Existing Footpath
 -  Existing Road
 -  Proposed Tactile Paving
 -  Proposed Footpath
 -  Pedestrian/Cycle Connectivity to Millwood



By	Date	Description

Drawing Status: PLANNING

Project Title:
Residential Development at Inch / Coollegreen,
Port Road, Killarney

Drawing Title:
Pedestrian Connectivity to the North of the
site to Millwood Estate

Client:
Portal Asset Holdings Ltd.



M.H.L. & Associates Ltd.
Consulting Engineers

Carrig Mór House,
10 High Street,
Douglas Road,
Cork.

Tel: 021-4840214
Fax: 021-4840215
E-Mail: info@mhl.ie

Designed: JD	Drawn: JD	Checked: BM
Scale: 1:100 @A1 1:200 @A3	Date: APRIL 2024	
Job No: 18137HD	Drawing No: PR-MHL-MC-P01	Revision: